

**H583 - ADA Camera Mount**  
for Huddly GO & Huddly IQ

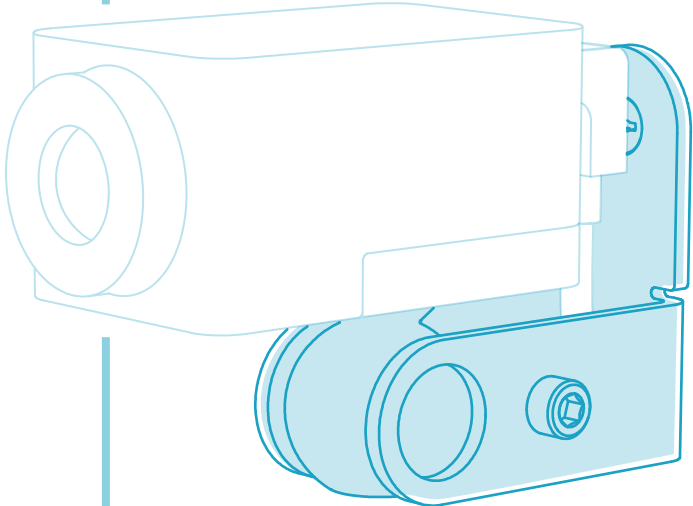

## IN THE BOX

- A** 1x ADA Camera Mount
- B** 1x Wall Anchor
- C** 1x Hex Key, 5/32"
- D** 1x Mounting Screw

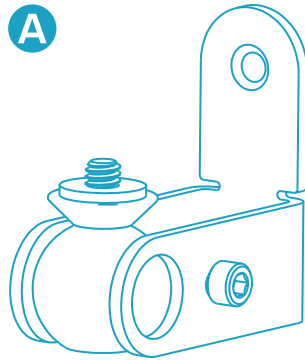

**B**



**C**



**D**



## TOOLS NEEDED



Tape Measure



Pen



Power Drill



Phillips  
head Bit



1/2" Spade  
Drill Bit

## COMPONENTS NEEDED (Not Included)

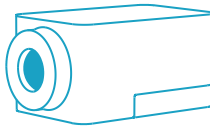

Huddly GO & Huddly IQ

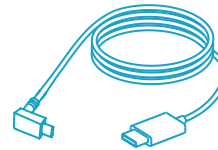

2m USB 3.0 Huddle Room/  
Desktop Cable

If you have any questions, please contact  
[service@hecklerdesign.com](mailto:service@hecklerdesign.com).

# STEP 1

## Locate mounting position

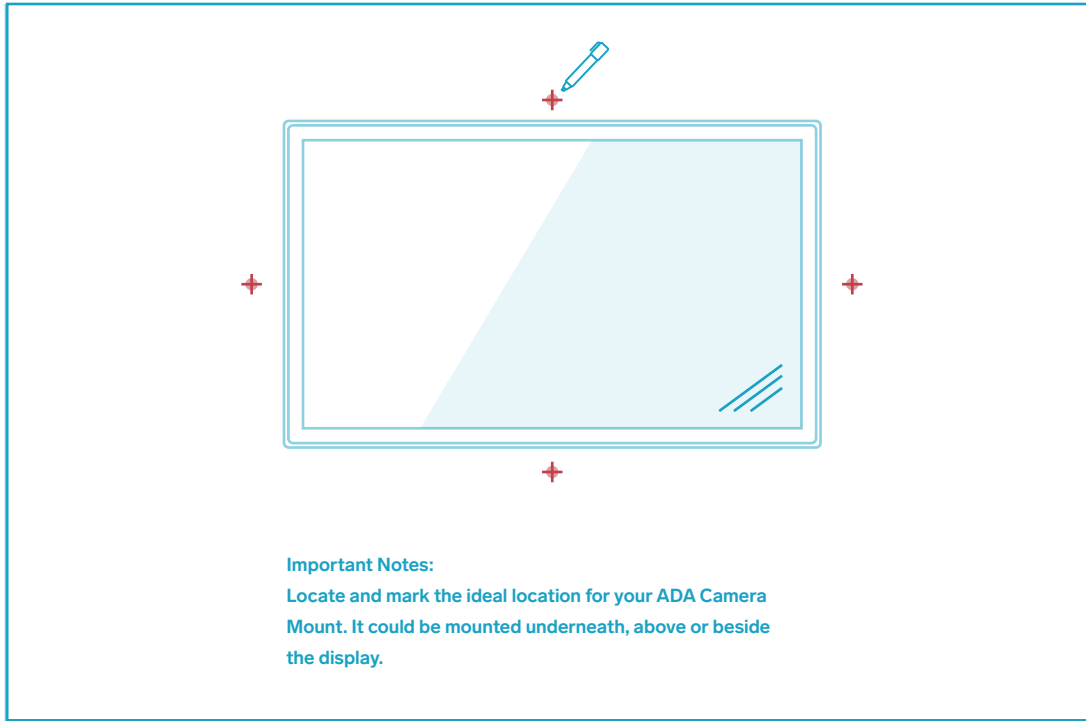

### Important Notes:

Locate and mark the ideal location for your ADA Camera Mount. It could be mounted underneath, above or beside the display.

## STEP 2

Install the wall anchor

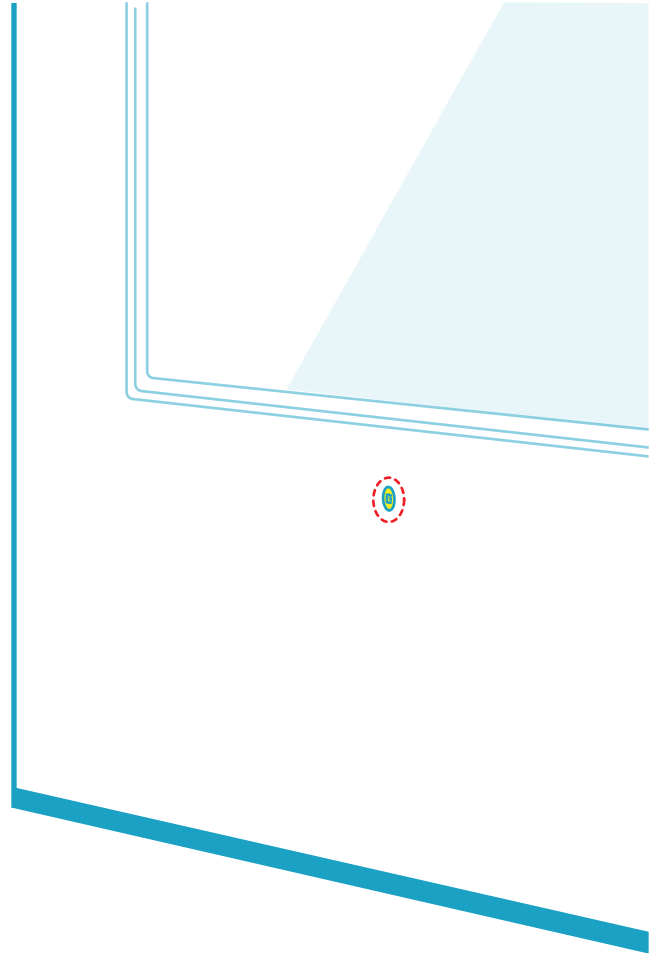
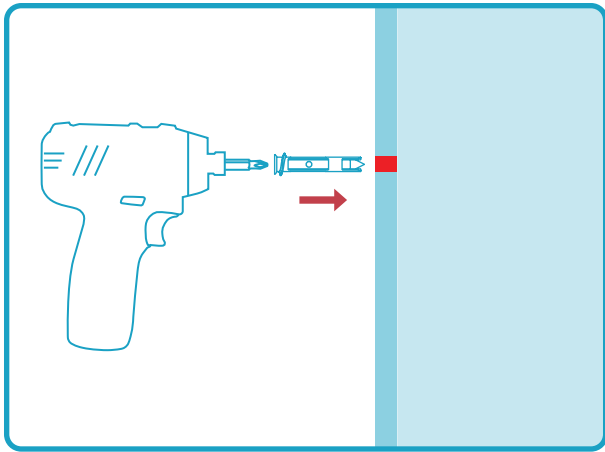

## Optional

### Mark and drill the hole



### Important:

Drill a 1/2-inch hole for the cable to pass through the wall.

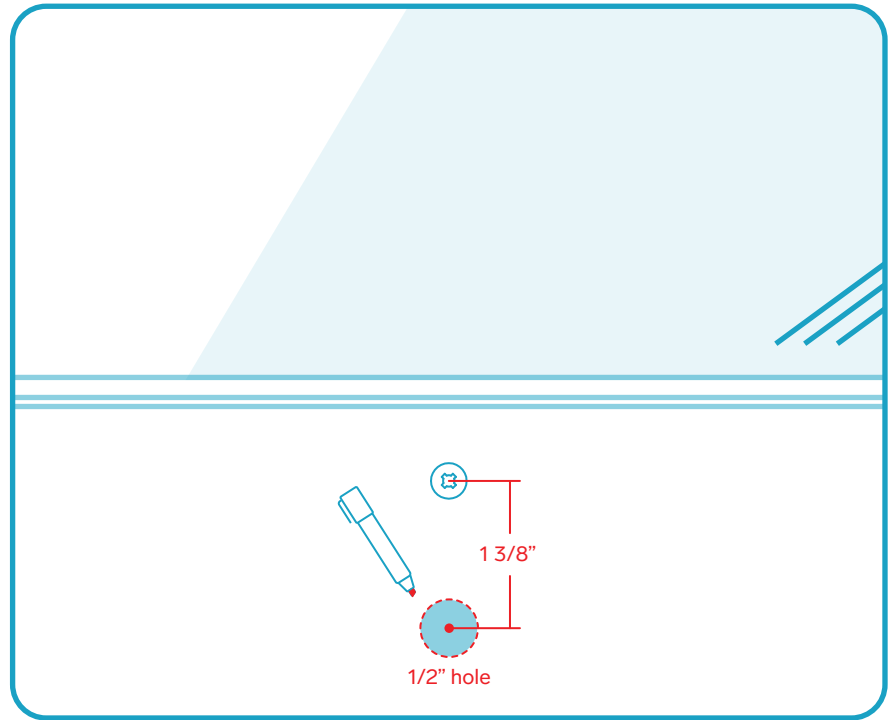

## Optional

Route the USB-C cable through the wall

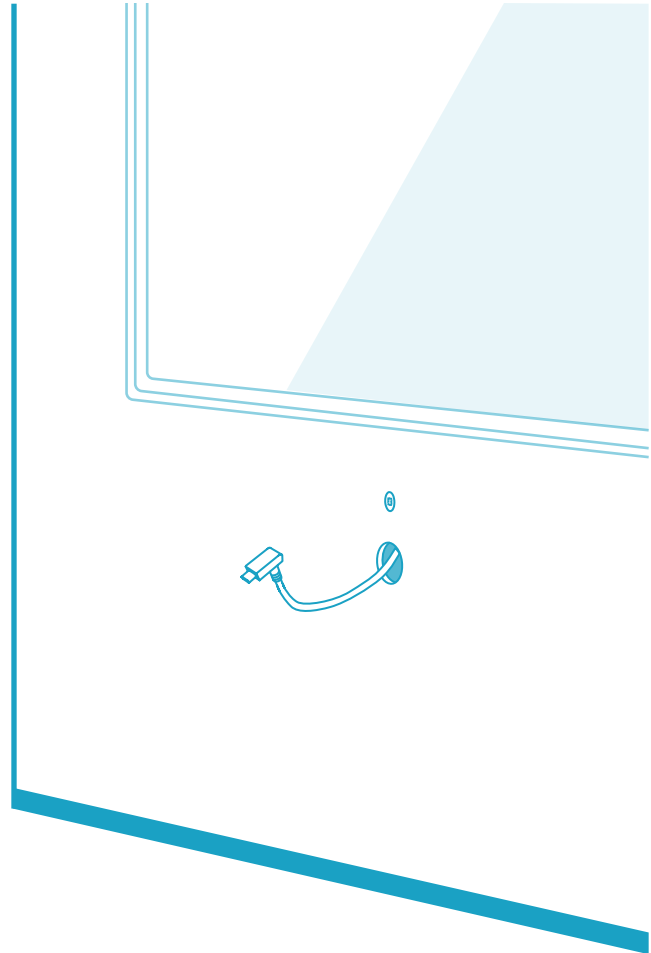
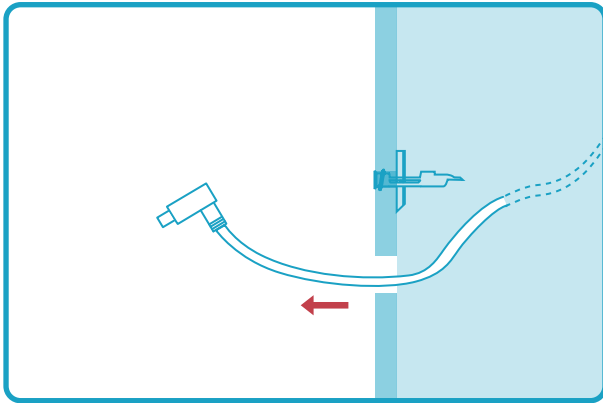

## STEP 3

### Fasten the ADA Camera Mount

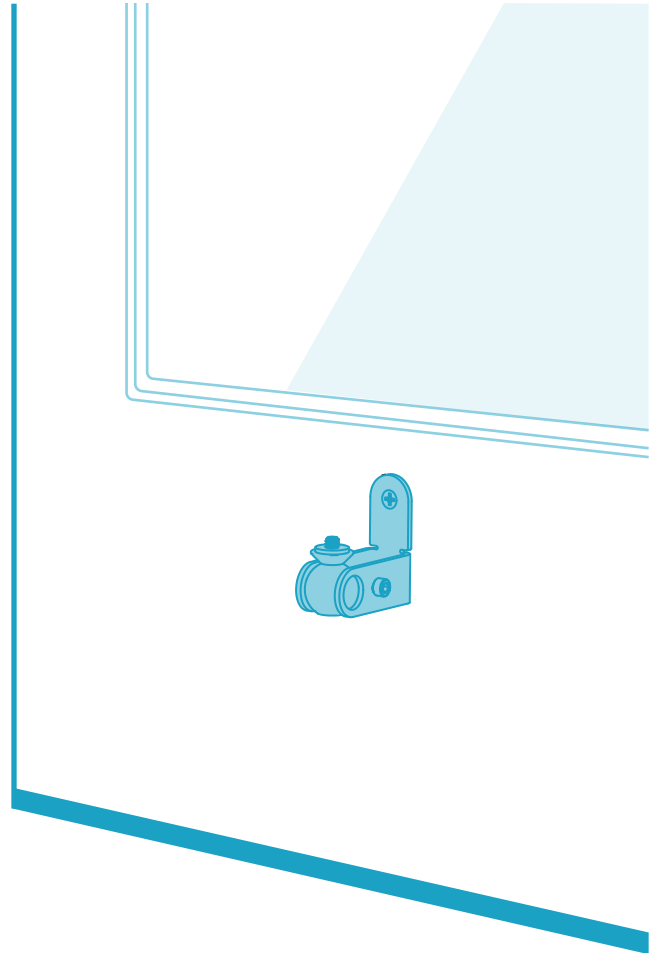
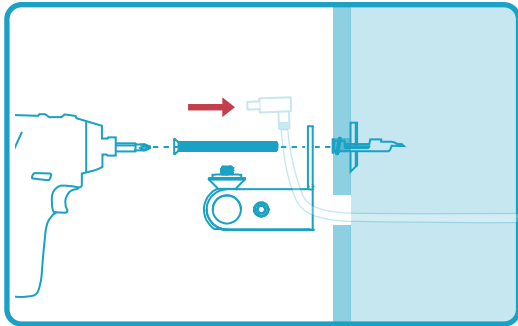



## STEP 4

### Install the Huddly GO or Huddly IQ

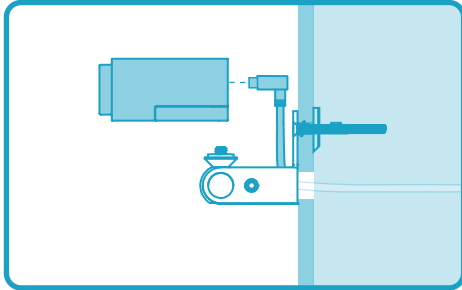

1. Connect the USB-C cable to Huddly GO or Huddly IQ Camera.

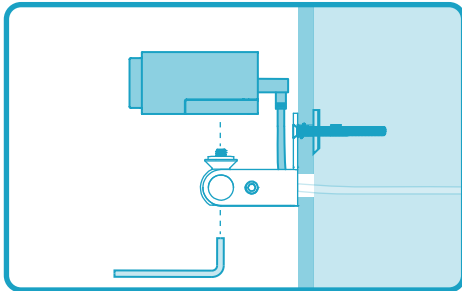

2. Fasten the camera to the ADA Camera Mount with the hex key.

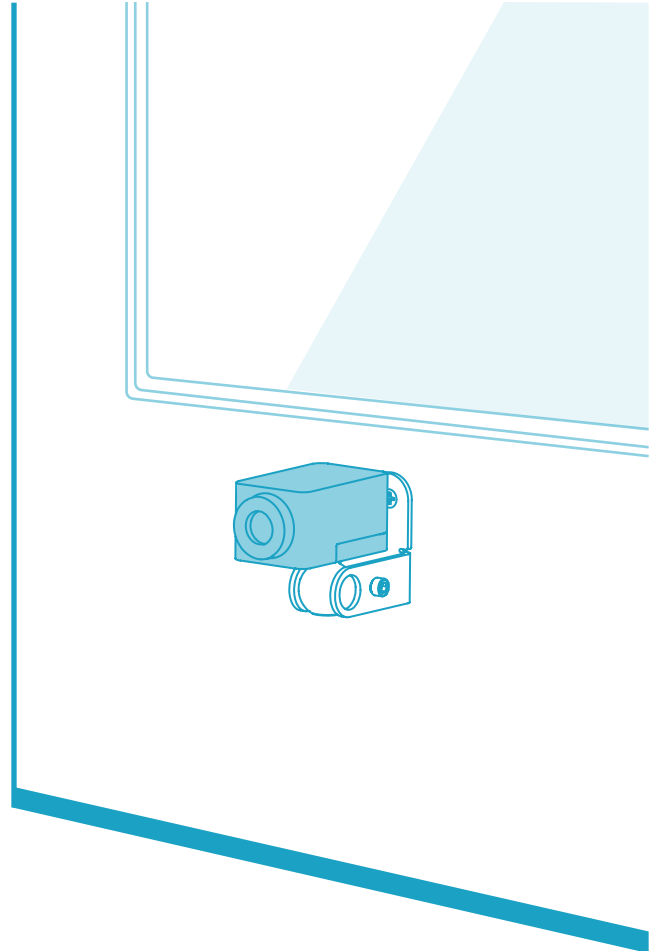

## STEP 5

Adjust and set camera orientation.

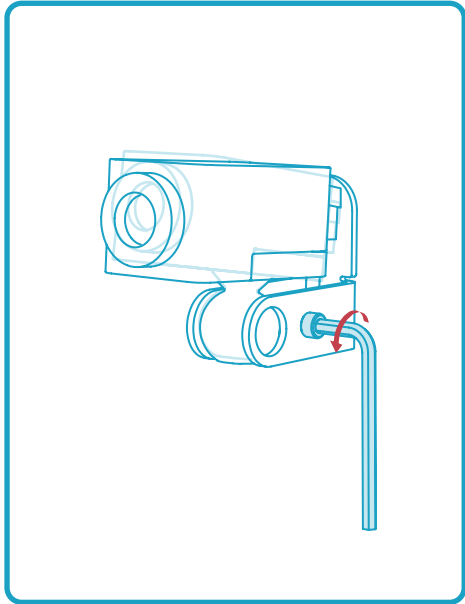

Loosen the screw with the hex key to adjust camera orientation, and then tighten it.

